

SAFETY & WARNINGS

READ AND FOLLOW ALL SAFETY INSTRUCTIONS

1. Do not puncture, cut, or shorten, fixture. Doing so causes risk of electric shock and will void the Safety Certification and warranty.
2. Do not use if there is any damage to the fixture or AC cord insulation. Inspect periodically.
3. All plastics are affected by the elements and may shift in color and other properties after product installation, particularly with direct exposure to sun, chlorinated water, and other chemicals.
4. Do not submerge fixture in liquids or use the product in the vicinity of standing water or other liquids.
5. Secure fixture using only hangers or mounting clips provided. Do not secure with staples, nails, its input wire, or like means that may damage the insulation or permanently attach the fixture to a building structure.
6. Do not subject fixture to continuous flexing.
7. Do not install near water.
8. Do not install in direct sunlight or damage to the LED phosphor will occur.
9. Do not attempt to fix this product in the field.

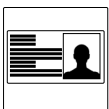

QUICK SPECS / MODELS

Input	120VAC, 60Hz
Power	See Specification Sheet
Max Run	300W
Environment	Indoor / Dry Location



WARNING!



THIS IS NOT A CUSTOMIZABLE FIXTURE.
DO NOT MODIFY.

CCT SELECT

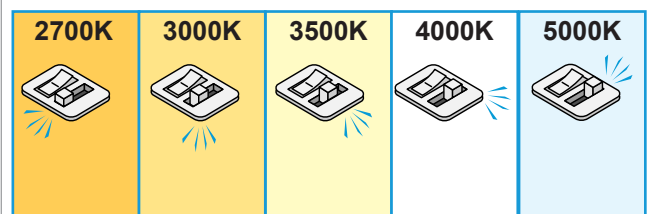

SABER™ Under Cabinet Light

INSTALLATION GUIDE

INSTALLATION

① TURN POWER OFF AT CIRCUIT BREAKER



SHOCK HAZARD! May result in serious injury or death.
Turn power OFF at circuit breaker prior to installation.

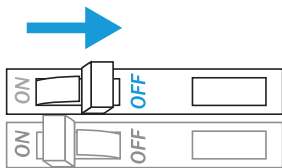

② MOUNT FIXTURE

2.1 Measure and mark surface, then remove captive screw covers.

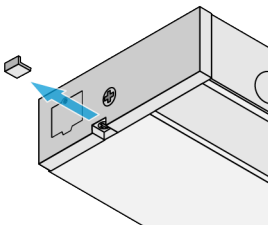

2.2 FASTEN FIXTURE TO SURFACE

Align Fixture to surface and mount with captive screws.

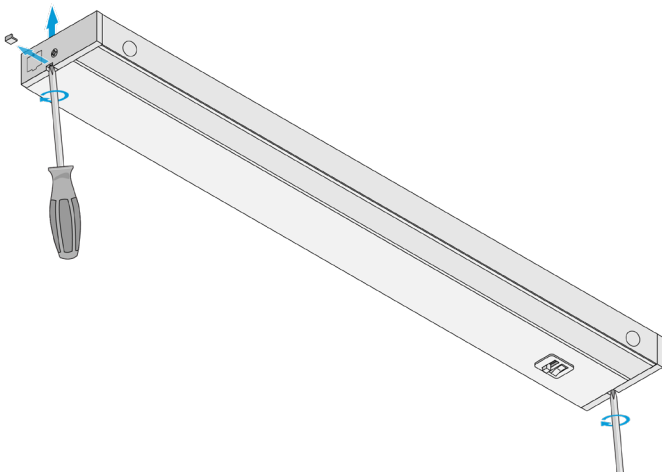

2.3 Replace captive screw cover.

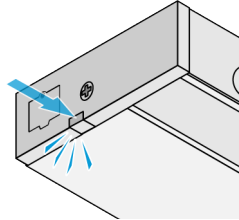

③ CONNECT FIXTURES TOGETHER

LINKABLE END-TO-END CONNECTOR

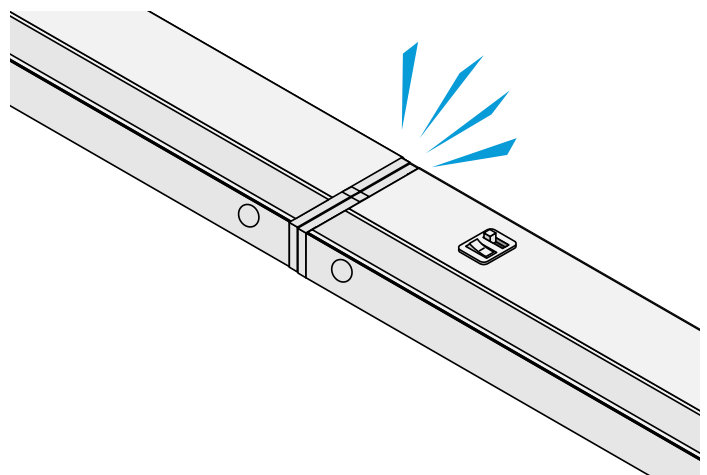
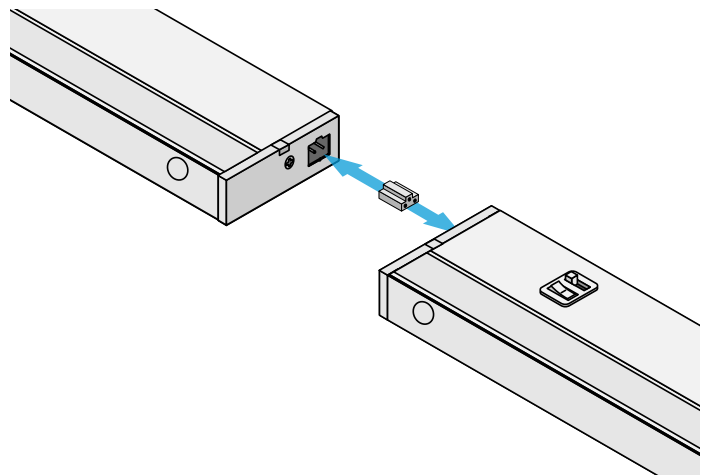

SABER™ Under Cabinet Light

INSTALLATION GUIDE

INSTALLATION (CONT.)

④ a CONNECT TO POWER (PLUG-IN CONNECTOR)

Connect power cable with AC plug into 120VAC receptacle.

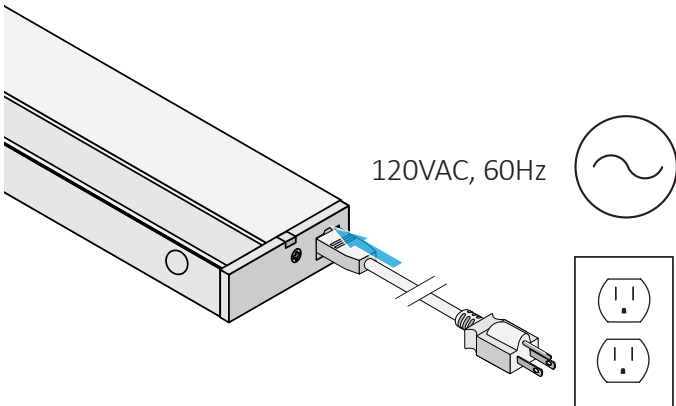

④ b CONNECT TO POWER (HARD WIRE CONNECTOR)

Insert connection wires into junction box, then using twist-on wire connection, connect wiring within Junction Box.

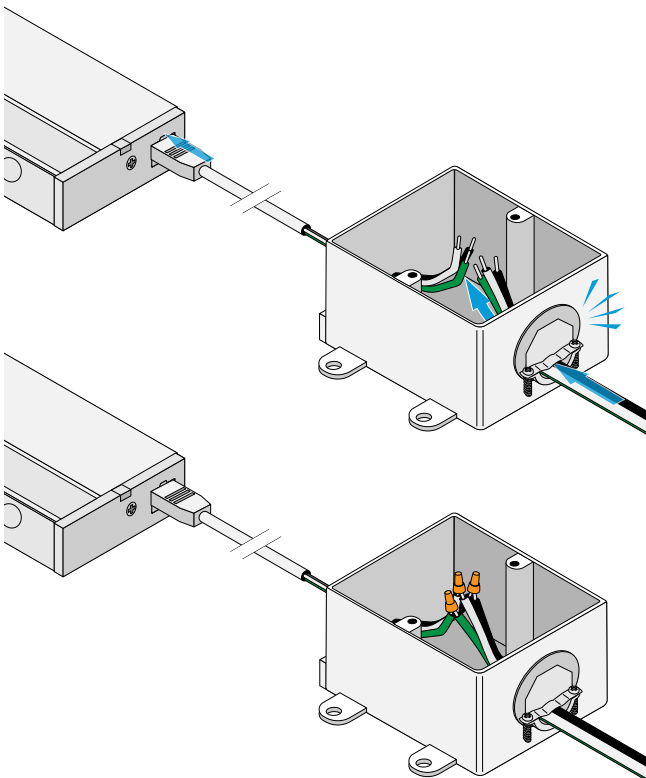

Using Phillips head screwdriver, fasten top to junction box.

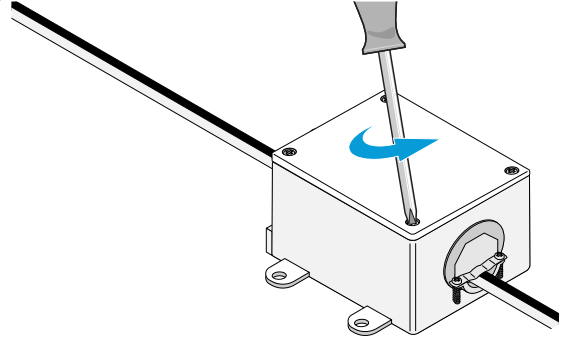

④ c CONNECT TO POWER (DIRECT HARD WIRE)

Open fixture cover by placing flathead screwdriver under lip then twisting.

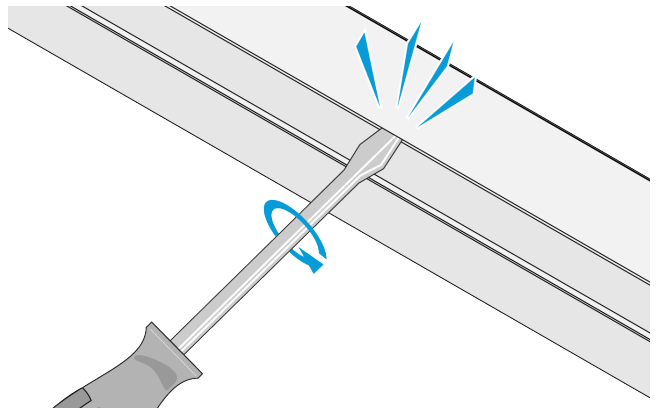

Open cover to gain access to wiring.

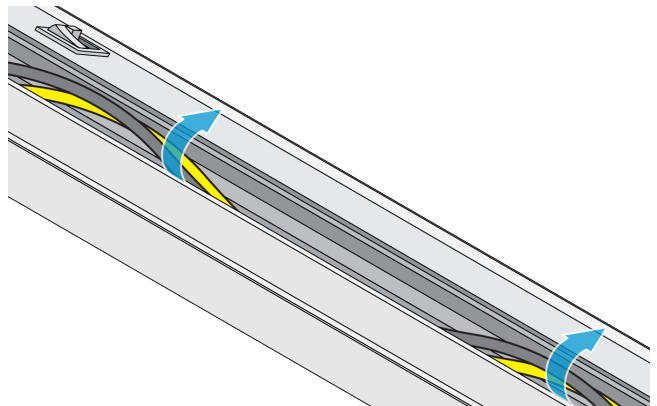

SABER™ Under Cabinet Light

INSTALLATION GUIDE

INSTALLATION (CONT.)

Remove knockout from back of fixture using hammer and flathead screwdriver.

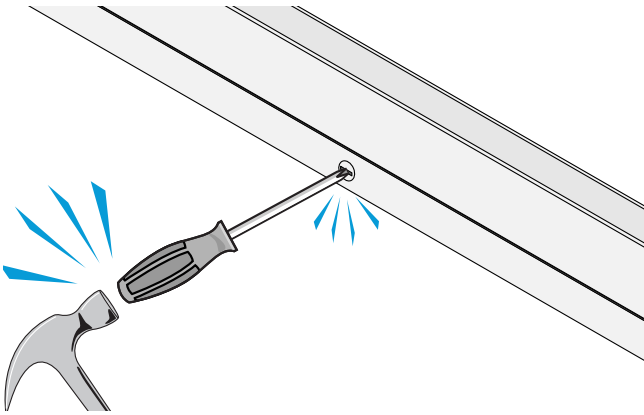

Connect wiring by inserting corresponding wires into terminal blocks

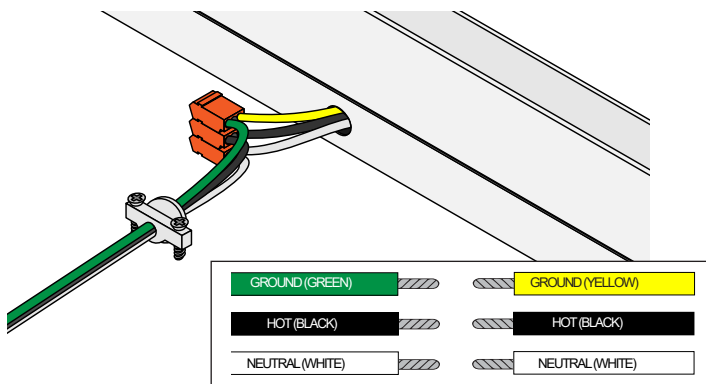

Fasten Strain Relief to back of fixture.

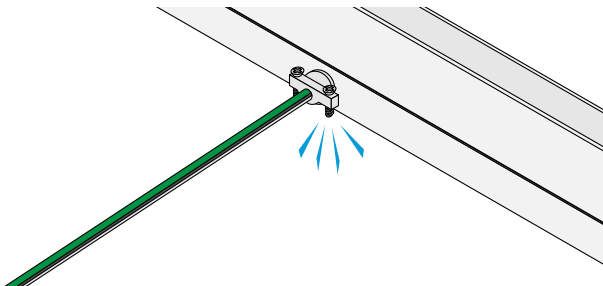

Close cover.

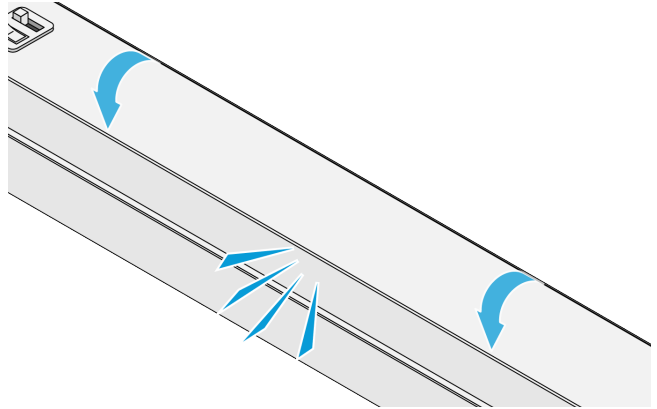

5 TURN POWER ON AT CIRCUIT BREAKER

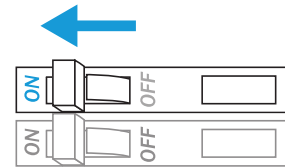

TROUBLESHOOTING

Lights are flickering

- Verify strip is connected to a 120VAC, 60Hz circuit.

Lights will not illuminate

- Ensure main power is turned On.
- Check wiring to ensure proper polarity.



Toll Free: 877.817.6028 | Fax: 415.592.1596 | www.DiodeLED.com | info@DiodeLED.com
© 2022 Elemental LED, Inc. All rights reserved. Specifications are subject to change without notice.